

PALECEK®

601 PARR BOULEVARD | RICHMOND | CA 94801

MOUNTING INSTRUCTIONS

RAVENNA MIRROR

173603, 173669

These instructions are provided for your convenience. It is very important that they are read carefully and completely before beginning installation of this item.

Tools Needed: Drill, Phillips head screw bit, Measuring tape, Hammer, Bubble Level, Pencil

Parts List:

- A) Mirror x 1 pc
- B) 10" Female Metal Cleat x 1 pc
- C) Wall Screws x 3 pcs
- D) Wall Anchors x 3 pcs

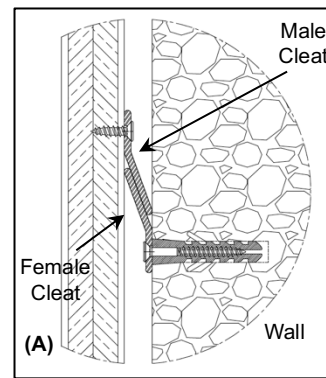
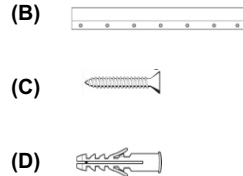

Side view of cleat engagement

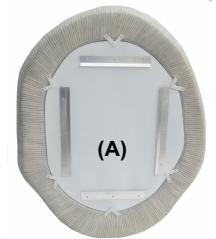

Back view of mirror

To Assemble:

1. Remove all parts and hardware from the box along with any plastic protective packaging. Do not discard contents until after assembly is complete to avoid accidentally discarding small parts or hardware.
2. Place components on a non-scratching surface.
3. Determine the desired location of the mirror. Mirror is equipped with 4 Male Metal Cleats for vertical or horizontal hanging.
4. Using the Female Metal Cleat, position cleat on wall in desired location and mark the hole locations on the wall with pencil.
NOTE: It is strongly recommended to install cleat with screws attaching directly into wall studs.
5. Use bubble level to ensure level positioning.
6. Using the drill, pre-drill holes at marked locations.
NOTE: If mirror location will be installed in sheet rock or masonry, use appropriate drill bit size to accommodate wall anchors at locations between wall studs. Using a hammer, gently tap anchors into the holes until they are flush with the wall. Anchors provided are for sheetrock. For masonry anchors, consult your local hardware store.
7. Place Female Metal Cleat over hole locations and insert screws accordingly.
8. Tighten screws firmly. Do not overtighten.
9. Lift the mirror, align the Male and Female Metal Cleats, then slide downwards firmly until cleats engage.
10. Installation is complete.

Care Instructions: Dust with a soft, dry cloth. Do not use abrasive cleaners