



BRAMBLE

PRODUCT TEARSHEET



Kraton Reception Desk 72"

Shown in: **DRW RNAT**

SKU: **28350**

Size: **72W x 35D x 31H in**



Overview

Kraton Reception Desk 72"

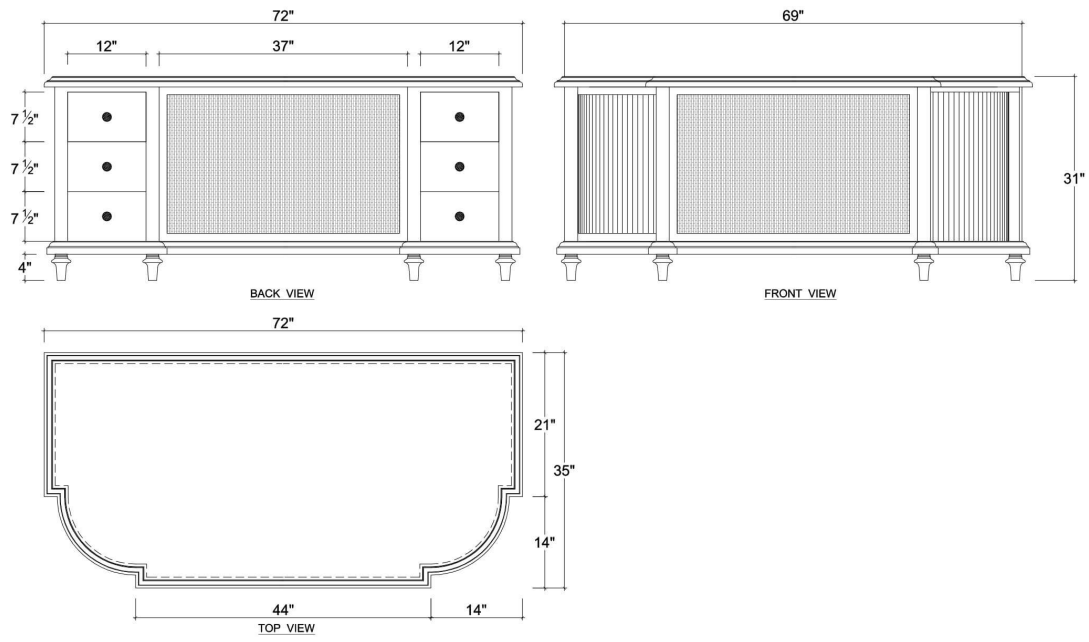

Visual Highlights





Technical Specification

Dimensions	72W x 35D x 31H in	CBM	1.49413
Number of Packages	1	Cubic Feet	52.77 ft³
Package 1 Dimensions	73.6 x 37 x 33.5 in	Net Weight	218.26 lbs
Package Weight Total	246.92 lbs		

<https://www.brambleco.com/28350>
